

SI. NO.	MMD NO.	SECTION	LENGTH	NO. OF PCS. (UNIT)	WT. PER SET (KG./M)	PCS. (KG.)	TOT. WT. (KG.)	REMARKS
1	1	PL300x25	300	4	136.25	545	70.64	
2	2	PL110x8	250	8	62.81	502.48	14.96	
3	3	PL110x10	250	8	62.81	502.48	14.96	
4	4	PL100x10x10	4105	2	16.51	67.22	135.48	
5	5	PL100x110x8	4105	2	16.51	67.22	135.48	
6	6	PL100x110x8	6008	2	13.41	60.48	160.98	
7	7	PL100x110x8	6008	2	13.41	60.48	160.98	
8	8	L80x80x8	4405	2	82.1	331.12	72.24	
9	9	L80x80x8	4405	2	82.1	331.12	72.24	
10	10	L80x80x8	2012	2	82.1	164.24	36.12	
11	11	L80x80x8	2012	2	82.1	164.24	36.12	
12	12	L80x80x8	2406	2	98.1	196.2	43.26	
13	13	L80x80x8	2318	2	98.1	196.2	43.26	
14	14	L80x80x8	2231	2	98.1	196.2	43.26	
15	15	L80x80x8	2150	2	98.1	196.2	43.26	
16	16	L80x80x8	2089	2	98.1	196.2	43.26	
17	17	L80x80x8	1991	2	98.1	196.2	43.26	
18	18	L80x80x8	1920	2	98.1	196.2	43.26	
19	19	L80x80x8	2104	2	98.1	196.2	43.26	
20	20	L80x80x8	950	4	82.1	328.4	72.24	
21	21	L80x80x8	950	4	82.1	328.4	72.24	
22	22	L80x80x8	1109	4	82.1	328.4	72.24	
23	23	L80x80x8	1380	4	82.1	328.4	72.24	
24	24	L80x80x8	1240	4	82.1	328.4	72.24	
25	25	L80x80x8	186	4	82.1	328.4	72.24	
26	26	L80x80x8	184	4	82.1	328.4	72.24	
27	27	L80x80x8	184	4	82.1	328.4	72.24	
28	28	L80x80x8	1920	4	82.1	328.4	72.24	
29	29	L80x80x8	2104	4	82.1	328.4	72.24	
30	30	L80x80x8	383	16	62.81	1004.96	224.64	
31	31	L80x80x8	419	4	10.8	43.24	9.12	
32	32	L75x75x6	419	4	62.81	251.24	55.68	
33	33	L75x75x6	383	8	62.81	502.48	111.36	
34	34	L75x75x6	419	4	62.81	251.24	55.68	
35	35	L45x45x5	1285	4	3.4	13.72	29.28	
36	36	L45x45x5	350	1	78.5	78.5	17.48	
		<b>Total</b>				<b>1953.36</b>	<b>9.62</b>	

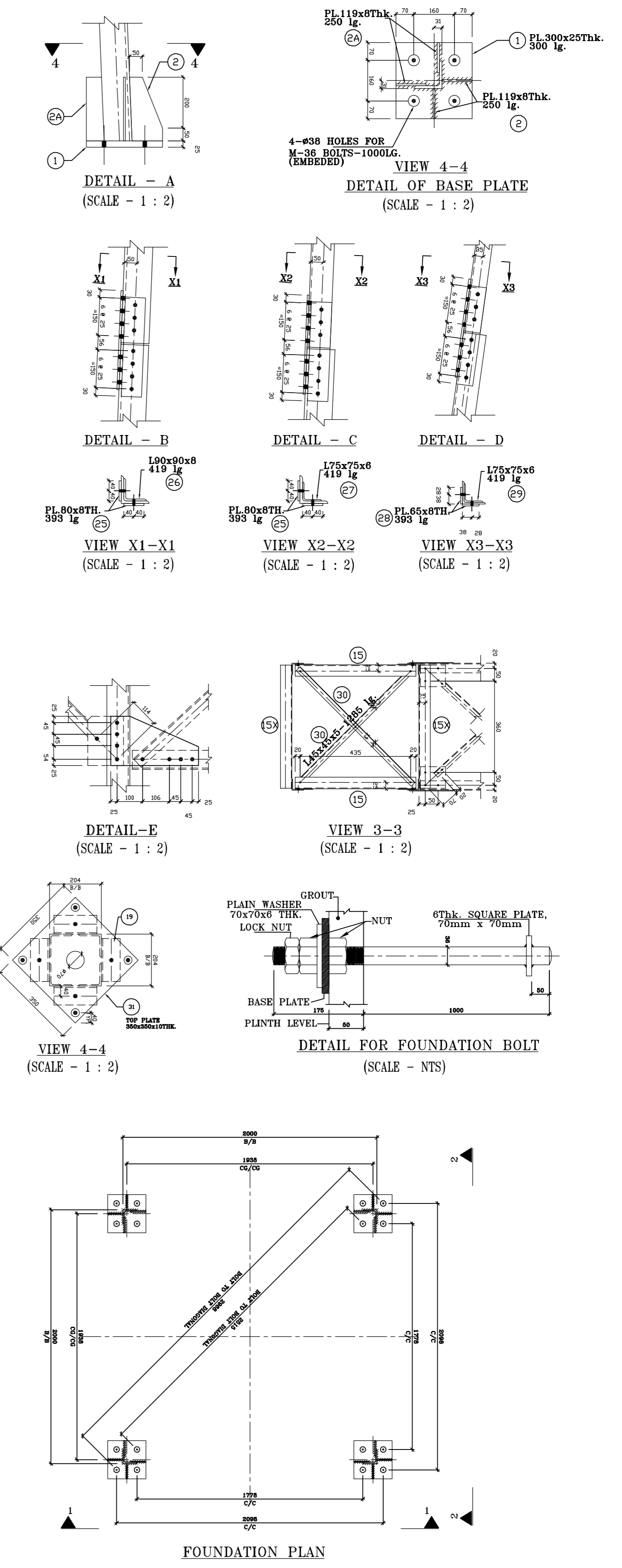

- NOTES:**
1. ALL DIMENSIONS ARE IN MILLIMETERS AND ALL LEVELS ARE IN METER UNLESS OTHERWISE SPECIFIED.
  2. ALL HOLES ARE 17.5mm TO SUIT HEX. BOLTS.
  3. SECTIONS NOT INDICATED ARE TO BE PLACED UNDER EACH HEX. NUTS.
  4. ONE SPRING WASHER 3.5mm THK. TO BE PLACED UNDER EACH HEX. NUTS.
  5. ALL STRUCTURAL STEEL ARE OF MILD STEEL AND SHALL CONFORM TO ASTM-A36; ASTM-A500; ASTM-A572 OR IS:2062-1992 (GRADE X-5 STANDARD QUALITY).
  6. ALL BOLTS AND NUTS ARE OF HEXAGONAL TYPE AND SHALL CONFORM TO ASTM-A307 (PROPERTY CLASS S30).
  7. ALL EXPOSED STRUCTURAL STEEL SHALL BE HOT DIP GALVANIZED WITH A MINIMUM COATING THICKNESS OF 550 g/m<sup>2</sup> AS PER SPECIFICATION.
  8. Z&C EXTRA. NUTS & BOLTS SHALL BE SUPPLIED FOR ERECTION.
  9. THIS B.O.M. IS ONLY AN INDICATIVE ONE. B.O.M. WILL BE FINALIZED AT THE TIME OF PROTO.

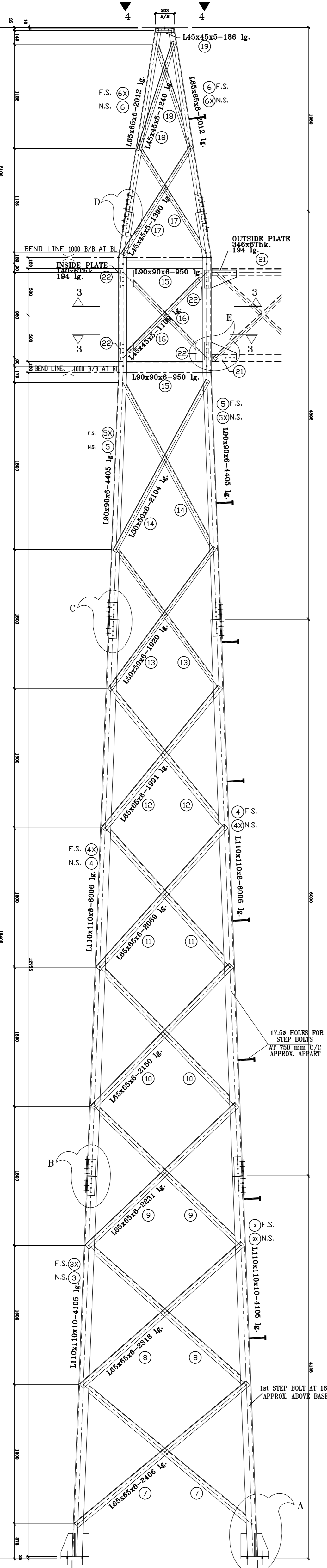
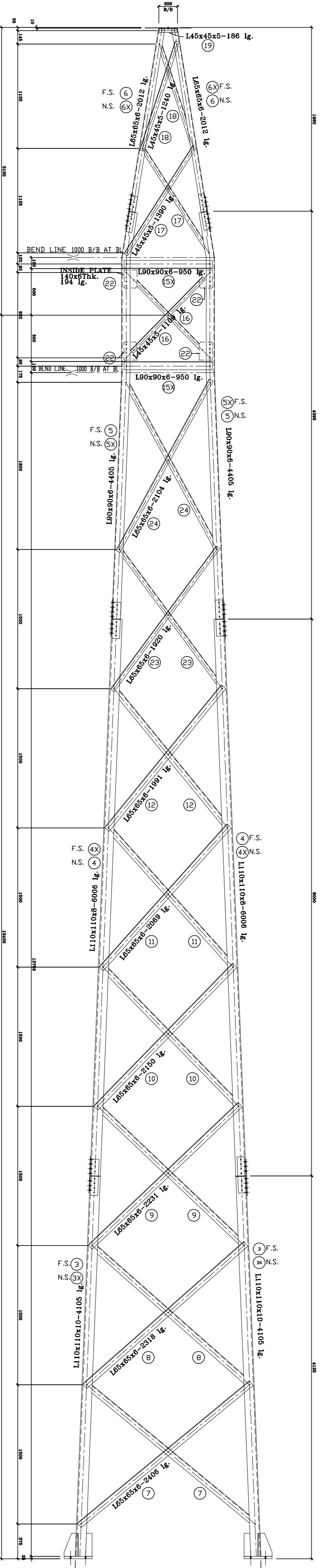

**REFERENCE DRAWINGS**

1. ORIGINAL STRUCTURAL LAYOUT OF GANTRY TOWER BEAM	10182/1/DES/SLY100
2. DESIGN CALCULATION FOR STRUCTURE	P1101-EBEG5

**FOR APPROVAL**

REV. NO.	REVISION COMMENTS	DATE	CHECK
1.	REUSED AS PER TDS COMMENTS	27/08/13	AD

**Client:** TRANSMISSION COMPANY OF NIGERIA

**Designer:** SATCON KOLKATA, INDIA

**Project Title & Drawing Title:** CONSTRUCTION OF 2x60MVA, 132/33KV SUBSTATION AT DAMBATTA

**GENERAL ARRANGEMENT OF STRUCTURES INCLUDING BOM AND WEIGHT FOR 132KV LINE TOWER MMD P1**

**Approval:** T.S. Check: AD Date: 01.10.13 Scale: 1:47

**File Ref:** P11004-EBBAGE