

We reserve all rights in this document and the information contained therein. Reproduction, use or disclosure to third parties without express authority is strictly prohibited.

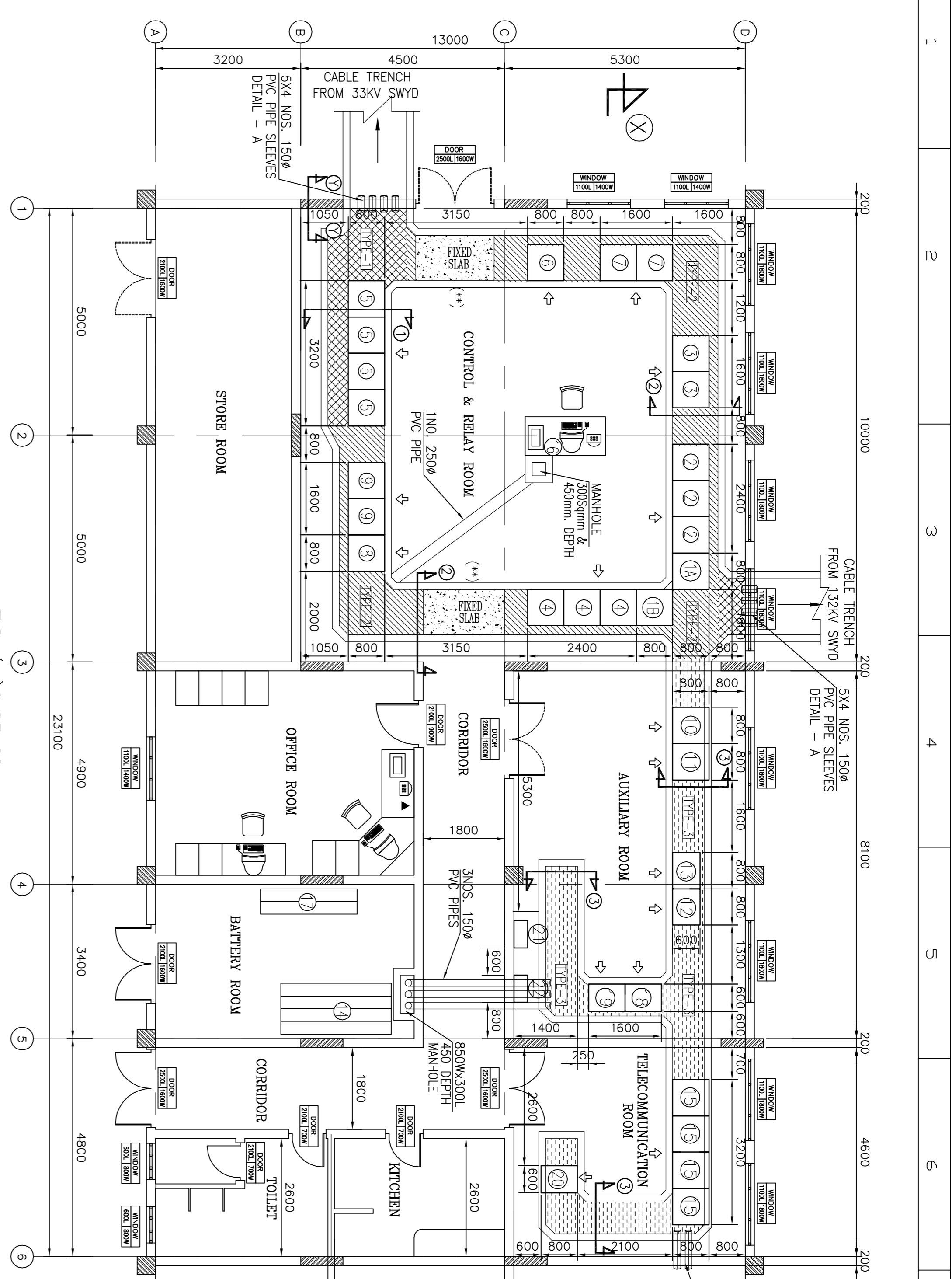

E.L. (+)0.25 M.
LAYOUT PLAN
(SCALE-1:100)

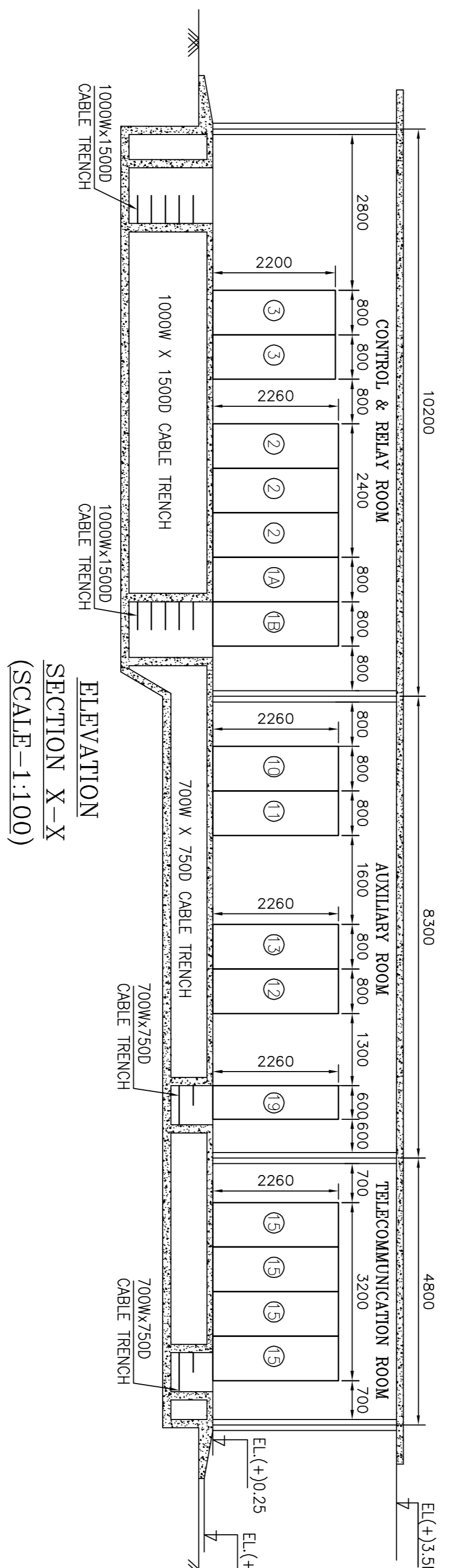

ELEVATION
SECTION X-X
(SCALE-1:100)

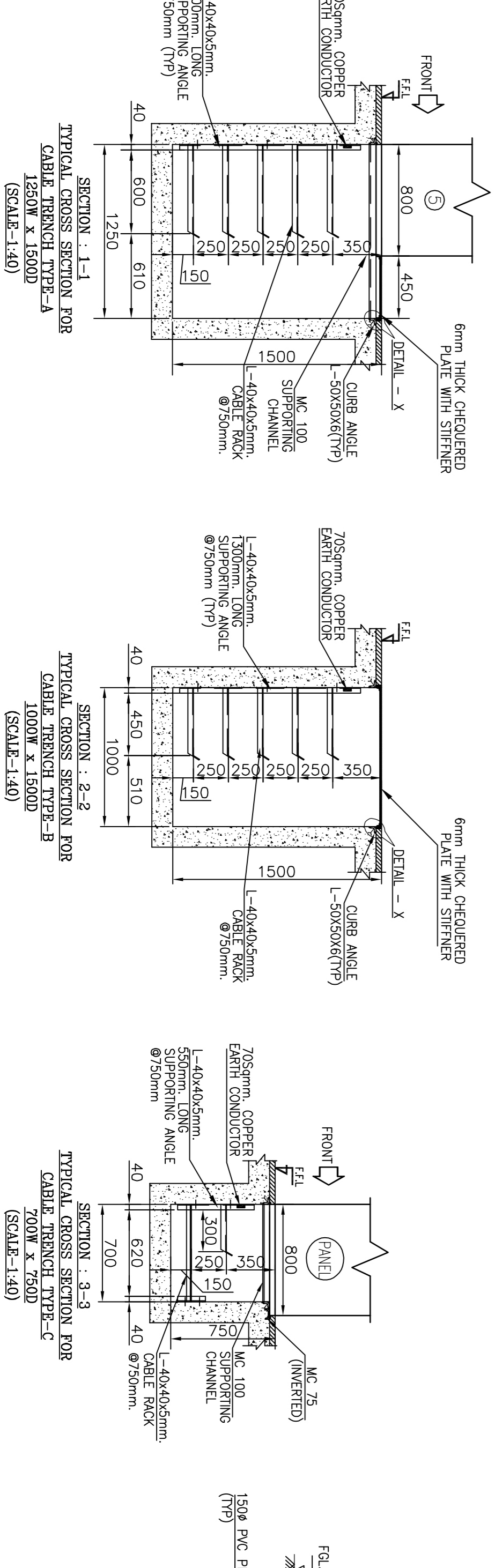

LEGEND :-

PANEL NO.	DESCRIPTION	QTY.
1A.	13KV GP FOR LINE DIAMETER	01 NO.
1B.	13KV GP FOR TRAFD DIAMETER	01 NO.
2.	13KV RP FOR LINE DIAMETER	03 NOS.
3.	GP FOR 132/33KV TRAFOS.	02 NOS.
4.	13KV RP FOR TRAFD. DIAMETER	03 NOS.
5.	33KV GP FOR O/G FURS. BC. BS	04 NOS.
6.	13KV BPP PANEL	01 NO.
7.	RTOC PANEL	02 NOS.
8.	COMMON PANEL/PART OF SAS	01 NO.
9.	SAS PANEL	02 NOS.
10.	AUTO TRANSFER SWITCH PANEL	01 NO.
11.	ACDB	01 NO.
12.	110V DCDB	01 NO.
13.	110V BATTERY CHARGER	01 NO.
14.	110V BATTERY	02 NOS.
15.	TELECOMMUNICATION EQUIPMENT & CONTROL DEVICES.	01 SET
16.	SAS DESK	01 SET
17.	48V BATTERY	01 NO.
18.	48V BATTERY CHARGER	01 NO.
19.	48V DCDB	01 NO.
20.	EPAX PANEL	01 NO.
21.	AC-LDB	01 NO.
22.	OLDB	01 NO.

BOQ OF PREFABRICATED RACK :-

SL	TRENCH TYPE	TRENCH LENGTH	ANGLE	QTY.
1.	TYPE-A	8.0M.	(5x0.65)M	1.1NOS.
2.	TYPE-B	30.0M.	(5x0.50)M	40NOS.
3.	TYPE-C	25.0M.	(1x0.35+1x0.7)M	34NOS.

NOTE - PLEASE CONSIDER A MARGIN OF 10% OVER THE ABOVE ESTIMATION TO BE ON SAFER SIDE.

** RACK(M.S ANGLE) QTY. :-
TOTAL LENGTH OF CABLE TRENCH
SUPPORTING STRUCTURE INTERVAL DISTANCE (0.75 M.)

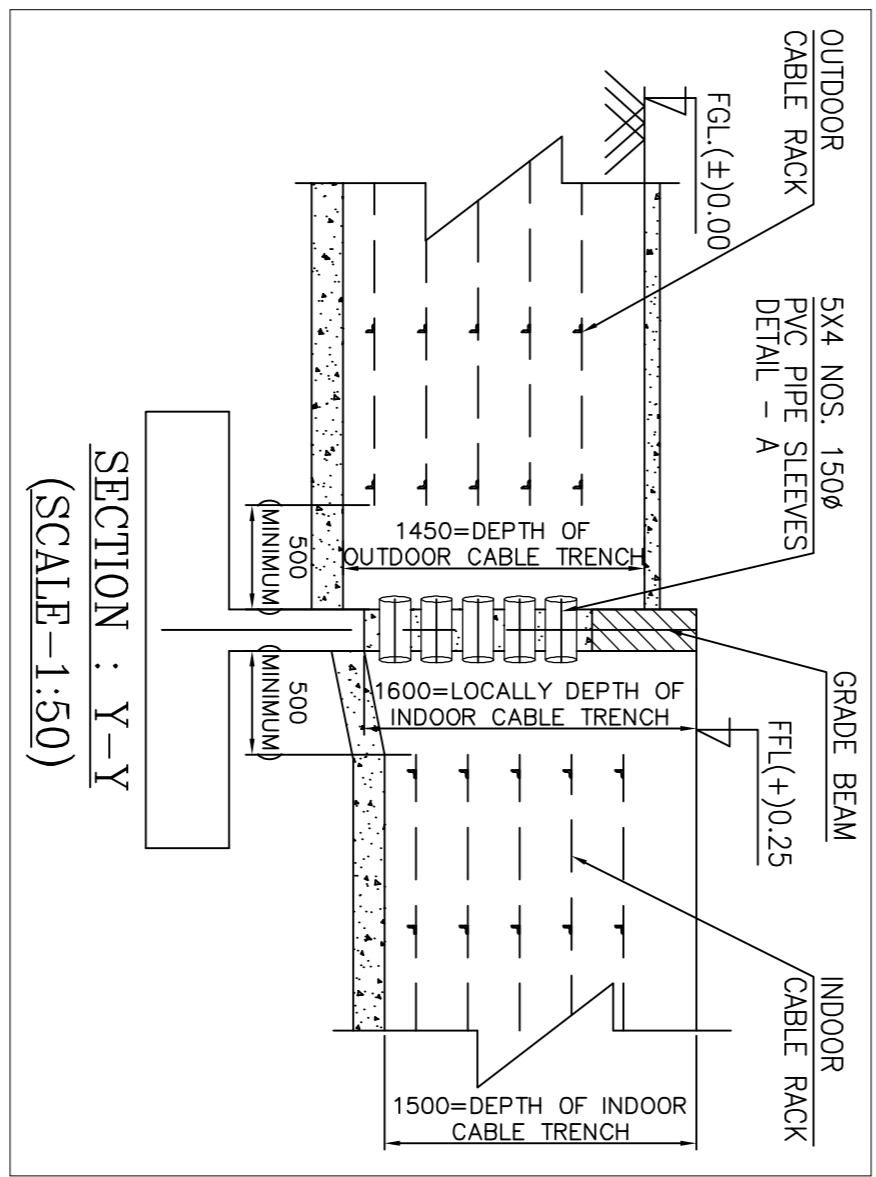

SECTION Y-Y
(SCALE-1:50)

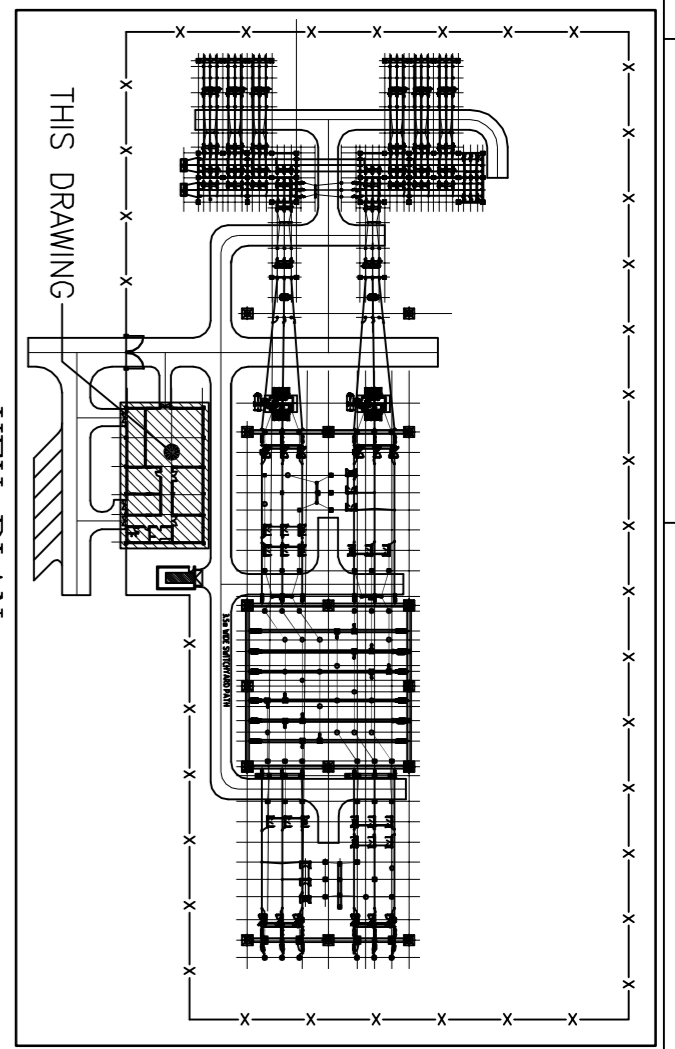

LEGEND FOR CABLE TRENCH :-

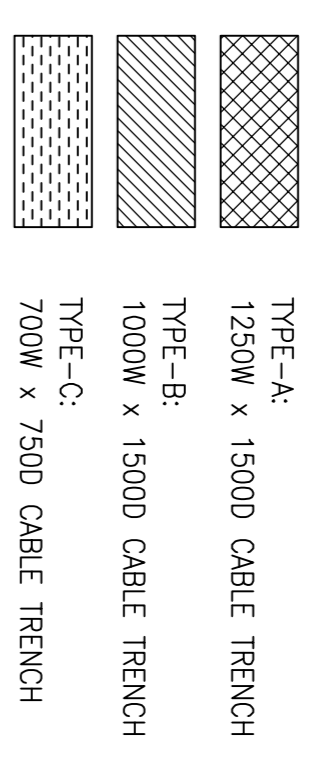

NOTE:

- ALL DIMENSIONS ARE IN MM AND LEVELS ARE IN M UNLESS OTHERWISE SPECIFIED.
- EQUIPMENT DIMENSIONS ARE INDICATIVE AND MAY CHANGE DURING DETAIL ENGINEERING.
- ALL CABLES IN THE CONTROL BUILDING SHALL BE LAID ON M.S. L-40x40x5 SUPPORTING RACKS IN TRENCHES.
- 70mm COPPER FLAT GROUNDING CONDUCTOR SHALL RUN ALONG THE CABLE TRENCHES FOR CABLE TRANS FERRING.
- IN CONTROL ROOM 6mm THICK CHECKERED PLATE SHALL BE PROVIDED ABOVE THE CABLE TRENCH.
- CABLE RACK SHALL BE PROVIDED AT EVERY 1.5M INTERVAL.
- THE RACKS SHALL BE ANCHOR FASTENED TO THE CONCRETE CABLE TRENCH WALL.
- FOR REINFORCEMENT DETAILS OF CABLE TRENCH AND CIVIL CONSTRUCTIONAL /STRUCTURAL ASPECT ETC. REFER APPROVED CIVIL DRAWINGS.
- ALL CABLE ENTRY POINT SHALL BE SEALED AND MADE VERMIN AND DUST PROTECTED. UN USED OPENINGS SHALL BE EFFECTIVELY SEALED.
- ALL CABLE RACKS SHALL BE PAINTED WITH TWO COATS OF RED OXIDE PRIMER AND FINISHED BY APPLICATION OF SYNTHETIC EMULS. PAINT OF BATTLE SHIP GRAY SHADE.
- THE PORTION OF SLAB MARKED (**) SHALL BE CAST AFTER COMPLETION OF CABLE LAYING.

REFERENCE DRAWINGS

- ELECTRICAL LAYOUT PLAN & ELEVATION OF SWITCHYARD
- P11004-EBLU

REV. NO.	REVISION NOTE	DATE	CHECK
2.	REVISED AS PER ION'S COMMENTS	03/06/13	AD

Drawing Status: FOR APPROVAL

Client: TRANSMISSION COMPANY OF NIGERIA

Consultant: SATCON, KOLKATA, INDIA

Project Title & Drawing Title: CONSTRUCTION OF 2x60MVA, 132/33KV SUBSTATION AT DAMBATHIA

Electrical Equipment Layout and Cable Trench Layout for Control Room Building

Design: TS, Check: AD, Sheet: 1 of 1

Approve: SM, Date: 04/06/2013, Scale: AS SHOWN

File Ref: P11004-EBLUHA, Drawing No., Rev. No. 2

Client: TRANSMISSION COMPANY OF NIGERIA

Consultant: SATCON, KOLKATA, INDIA

Project Title & Drawing Title: CONSTRUCTION OF 2x60MVA, 132/33KV SUBSTATION AT DAMBATHIA

Electrical Equipment Layout and Cable Trench Layout for Control Room Building

Design: TS, Check: AD, Sheet: 1 of 1

Approve: SM, Date: 04/06/2013, Scale: AS SHOWN

File Ref: P11004-EBLUHA, Drawing No., Rev. No. 2